



MA SERIES

- MULTI ATTACHMENT PULVERIZER
- FRANTUMATORE MULTI ATTACHMENT
- BROYEUR MULTI ATTACHMENT
- DEMOLEDOR MULTI ATTACHMENT
- MULTI ATTACHMENT PROZESSOR

		MA 15	MA 18	MA 25	MA 35	MA 50	MA 65	MA 130
body	kg.	875	1330	1680	2430	3560	4100	8600
H1	mm.	1060	1250	1360	1655	1560	1725	2250
max bar	bar	350	350	350	350	350	350	350
l/min.		150 / 250	150 / 250	200 / 300	300 / 400	400 / 500	400 / 600	500 / 800
max bar	bar	140	140	140	140	140	140	140
l/min.		20 / 40*	20 / 40*	25 / 50*	25 / 50*	25 / 50*	25 / 50*	80*
		/	/	/	/	✓	✓	✓

H = H1 + H2
 *Double motor / *Doppio motore / *Double moteur / *Doble motor / *Doppelmotor

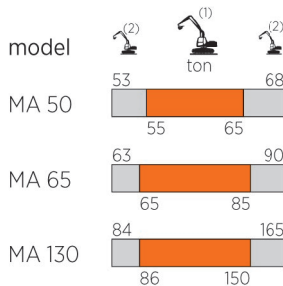
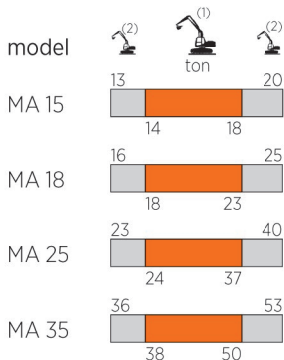

(1) Optimum excavator-equipment combination
 Accoppiamento escavatore-attrezzatura ottimale
 Coupelage pelle-équipement optimal
 Acoplamiento excavadora-implemento optimal
 Optimale Bagger-Ausrüstung Kombination

(2) Possible excavator-equipment combination
 Accoppiamento escavatore-attrezzatura possibile
 Coupelage pelle-équipement possible
 Acoplamiento excavadora-implemento possible
 Mögliche Bagger-Ausrüstung Kombination

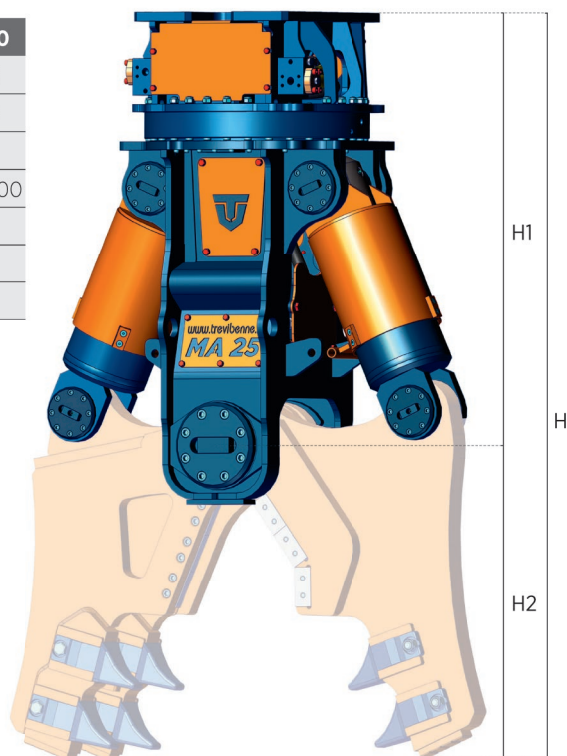

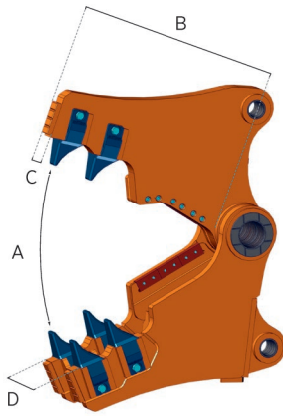
KIT CB

		MA 15	MA 18	MA 25	MA 35	MA 50	MA 65	MA 130
kg.		430	560	1020	1200	2060	2450	4220
A	mm.	700	740	860	1005	1280	1430	1940
B	mm.	710	790	905	960	1315	1440	1600
C	mm.	125	145	145	165	165	165	165
D	mm.	275	330	420	420	460	480	560
	mm.	350	350	375	525	525	525	660
H2	mm.	735	810	990	990	1340	1505	1590
Ø max	mm.	35	40	45	60	70	80	100
IPN max	mm.	/	/	/	/	/	/	/
HEA max	mm.	/	/	/	/	/	/	/
Lamiera max	mm.	/	/	/	/	/	/	/

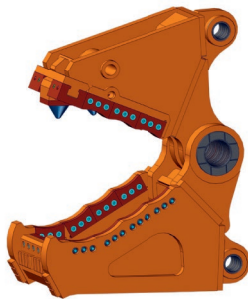
UPDATED
UPDATED
UPDATED
KIT CH

		MA 15	MA 18	MA 25	MA 35	MA 50	MA 65	MA 130
kg.		645	785	1145	1470	*	*	*
A	mm.	420	445	550	765	*	*	*
B	mm.	665	675	810	935	*	*	*
C	mm.	335	380	380	410	*	*	*
D	mm.	435	505	525	555	*	*	*
	mm.	390	450	620	750	*	*	*
H2	mm.	765	790	950	1055	*	*	*
Ø max	mm.	35	40	45	60	*	*	*
IPN max	mm.	/	/	/	/	*	*	*
HEA max	mm.	/	/	/	/	*	*	*
Lamiera max	mm.	/	/	/	/	*	*	*

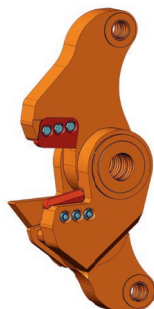
NEW PRODUCT
KIT RS

		MA 15	MA 18	MA 25	MA 35	MA 50	MA 65	MA 130
kg.		*	*	740	*	*	*	*
A	mm.	*	*	240	*	*	*	*
B	mm.	*	*	250	*	*	*	*
C	mm.	*	*	120	*	*	*	*
D	mm.	*	*	340	*	*	*	*
	mm.	*	*	200	*	*	*	*
H2	mm.	*	*	375	*	*	*	*
Ø max	mm.	*	*	/	*	*	*	*
IPN max	mm.	*	*	/	*	*	*	*
HEA max	mm.	*	*	/	*	*	*	*
Lamiera max	mm.	*	*	12	*	*	*	*

*Available on request / *Disponibile su richiesta / *Disponible sur demande / *Disponibile a petición / *Verfügbar auf Anfrage