

14 - 24t



RBS20

Sleeper Changer with Ballast Shield

Multi purpose sleeper changing unit RBS20 for the extraction and exchange of railway ballast and concrete or wooden sleepers of different shapes and sizes. The RBS20 with Ballast Shield is ideal for road rail excavators with 14t - 24t / 30,800 - 52,800 lbs operating weight.

- ▽ **Efficiency:** the large shield with buckets clears the track from the ballast. The sleeper is then grabbed by the hydraulically operated gripper and pulled out from the ballast bed. Once the new sleeper is placed, the shield is used to bring back and level the ballast again.
- ▽ **Bibloc sleepers** can be gripped hydraulically by spreading the clamps.
- ▽ **Safety:** a special holding valve provides a safe grip - even if pressure drops.
- ▽ **Reduced wear** due to the use of HARDDOX quality steel.
- ▽ **Bolt-on adapter:** available for different quick coupling systems.
- ▽ **360° endless rotation** due to the integrated 15t-rotator.
- ▽ **3 bolt-on ballast buckets**, exchangeable in a few minutes.
- ▽ **Adjustable plunge depth of shield** via adjustable limit rods.
- ▽ **Short version with adjusted kinematics** RBS20-S: gripping unit directly mounted to the shield.



RBS20-S

Sleeper Changers RBS20 with Shield

Typ	Gripping range	Weight	Length D	Height C	Width E	Gripper elements	Load capacity
	min. - max. (mm/in)						
RBS20	240 - 300 / 9.5 - 11.8	1,260 / 2,770	2,800 / 110.2	1,320 / 52.0	1,840 / 72.4	4	2,000 / 4,400
RBS20-S	240 - 300 / 9.5 - 11.8	1,160 / 2,552	2,800 / 110.2	1,220 / 48.0	1,570 / 61.8	4	2,000 / 4,400

Package consists of: sleeper changing unit with ballast shield and 3 bolt-on ballast buckets, KINSHOFER rotator KM 15 F273/273, non-return valve

Zubehör

Type	Description
T650 rigid	bolt-on adapter for "Atlas" quick coupler T620

Note: for adapters see mounting options.

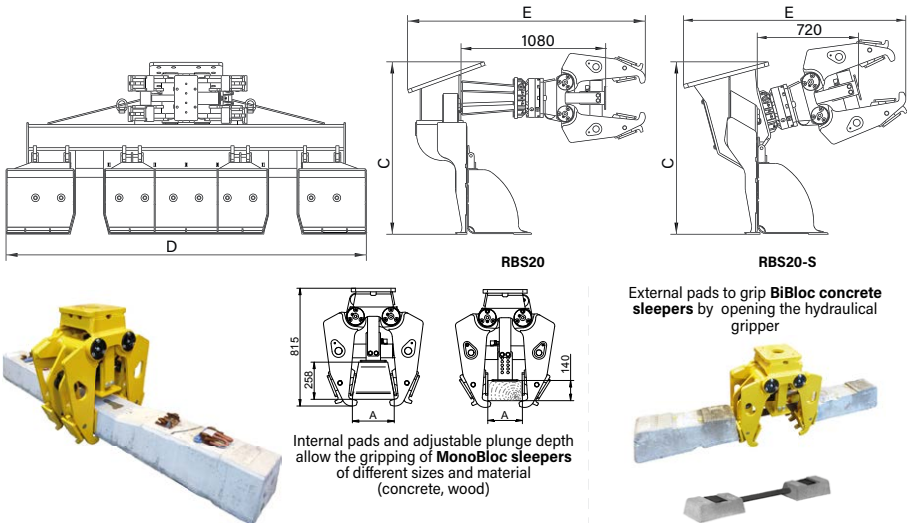

Requirements of Excavator

Two hydraulic circuits needed.

Operating pressure
(open/close)
max. 20 MPa (200 bar) /
2,880 psi

Operating pressure
(rotate)
max. 35 MPa (350 bar) /
5,040 psi

Recommended oil flow
(open/close)
50 - max. 75 l/min /
13.2 - max. 19.8 GPM

Recommended oil flow
(rotate)
20 - max. 50 l/min /
5.3 - max. 13.2 GPM